



NOTES

1. Working Dimensions.
The contractor shall verify, ascertain and agree upon all other drawings and dimensions prior to the start of the work.
2. Existing Services.
The contractor shall be responsible for the location of existing services included on this drawing is intended for general guidance only. It shall be the responsibility of the contractor to verify the location of all services and to protect them during the construction of the proposed works. The contractor shall be responsible for the location of all services and to protect them during the construction of the proposed works. The contractor shall be responsible for the location of all services and to protect them during the construction of the proposed works.
3. Base of Drawings.
Here copies, and not all form a complete base of the drawings. The contractor shall be responsible for the location of all services and to protect them during the construction of the proposed works. The contractor shall be responsible for the location of all services and to protect them during the construction of the proposed works. The contractor shall be responsible for the location of all services and to protect them during the construction of the proposed works.
4. Datum.
The contractor shall be responsible for the location of all services and to protect them during the construction of the proposed works. The contractor shall be responsible for the location of all services and to protect them during the construction of the proposed works. The contractor shall be responsible for the location of all services and to protect them during the construction of the proposed works.

Existing Layout
Proposed Layout
Work Boundary

rev	amendments	drawn	date

RPS
Engineering
14-15, The Quadrant, Bournemouth, Dorset, BH1 1JN
Tel: 01202 506000
Fax: 01202 506001
Email: info@rps.co.uk
Website: www.rps.co.uk

Client
Islandmagee Gas Storage

Project
Islandmagee Gas Storage

Title
Overall Site Layout

Drawing Status
Preliminary
Sheet Size
A0
Drawing Scale
AS SHOWN

Drawing Number
IBH0287/0010

Project Leader
BD
Drawn By
COC
Date
Sep 2011
Initial Review
COC

NOTES

1. Verifying Dimensions.
The contractor shall verify dimensions against such other drawings or site conditions as pertain to this part of the work.
2. Existing Services.
Any information concerning the location of existing services indicated on this drawing is intended for general guidance only. It shall be the responsibility of the contractor to determine and verify the exact horizontal and vertical alignment of all cables, pipes, etc. (both underground and overhead) before work commences.
3. Issue of Drawings.
Hard copies, dwf and pdf will form a controlled issue of the drawing. All other formats (dwg, dxf etc.) are deemed to be an uncontrolled issue and any work carried out based on these files is at the recipient's own risk. The contractor shall be responsible for any errors arising from the use of these files, either by passing on to the recipient, listing of un-dimensioned measurements, compatibility issues with the recipient's software, and any errors arising when these files are used to aid the recipient's drawing production, or setting out on site.
4. Datum.

Existing Layout
Proposed Layout
Works Boundary

LEVEL DATUM=35.00	
EXISTING LEVELS	
CHAINAGE	
200.000	57.41
220.000	59.02
240.000	61.12
260.000	63.25
280.000	64.58
300.000	65.63
320.000	66.42
340.000	66.78
360.000	67.09
380.000	67.19
400.000	67.18
420.000	67.55
440.000	67.80
460.000	68.61

Site Access
Visibility

VERTICAL 1:500
HORIZONTAL 1:500

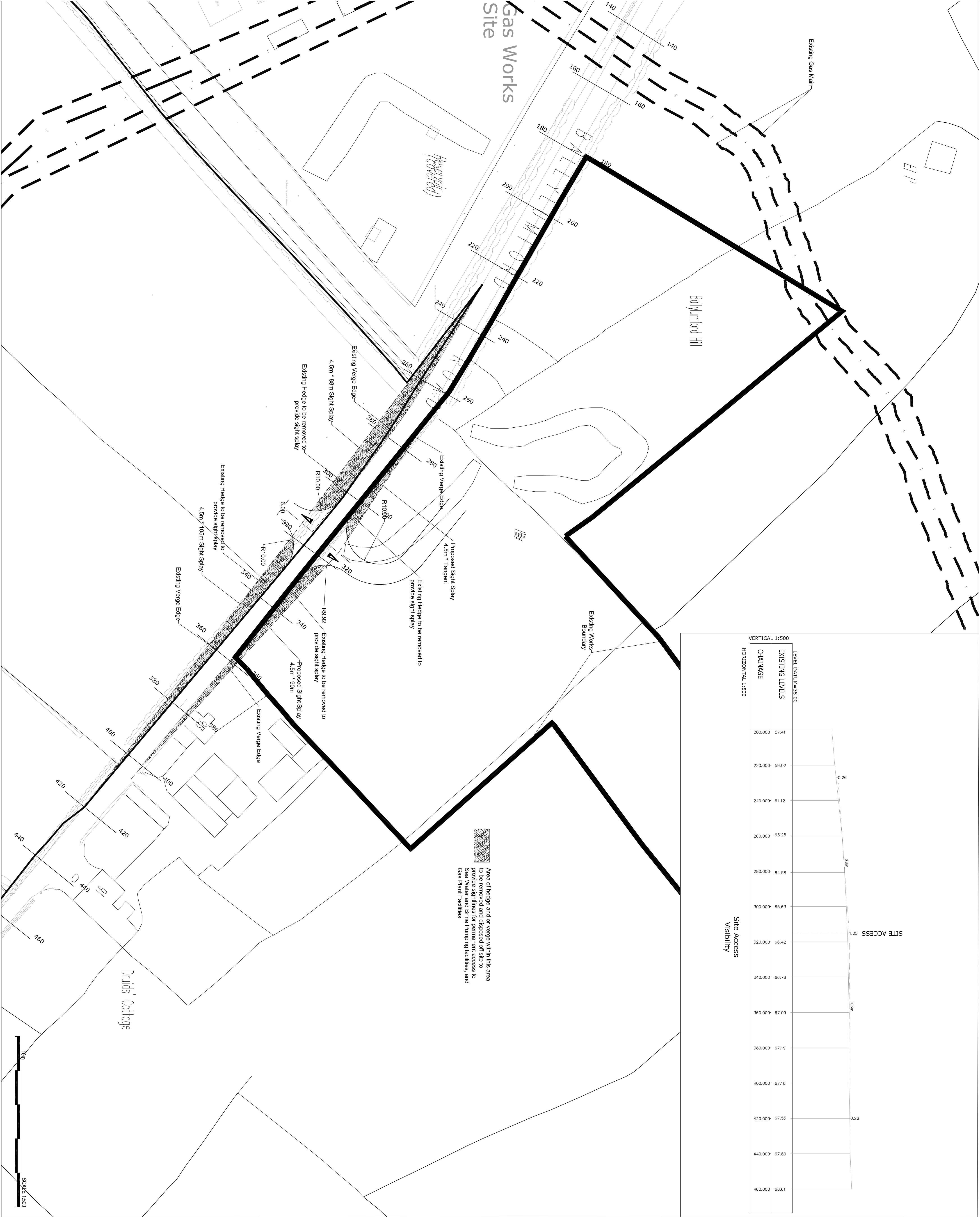

rev	amendments	drawn	date

Edmund House
74 Boucher Road
Belfast
BT12 6FZ

T +44 (0) 28 90 667914
F +44 (0) 28 90 668286
W www.rpsgroup.com/ireland
E ireland@rpsgroup.com

Client
Islandmagee Storage Limited

Project
Islandmagee Gas Storage

Title
Site Access 1 - to the Sea Water and Brine Pumping Facilities and Main Gas Plant Facilities

Drawing Status	Sheet Size	Drawing Scale
Preliminary	A1	AS SHOWN

Drawing Number	Rev
IBH0287 /0020	/

Project Leader	Drawn By	Date	Initial Review
B.D	C.O.C	Sept 2011	C.O.C

NOTES

1. **Verifying Dimensions.**
The contractor shall verify dimensions against each other drawings or site conditions as pertain to this part of the work.
2. **Existing Services.**
Any information concerning the location of existing services indicated on this drawing is intended for general guidance only. It shall be the responsibility of the contractor to determine and verify the exact horizontal and vertical alignment of all cables, pipes, etc. (both underground and overhead) before work commences.
3. **Base of Concrete.**
Bases of concrete, dead and soft, from a controlled source of the drawing. All other materials (rock, etc.) deemed to be an authorized basis and/or work carried out, based on these files is at the recipient's own risk. RPS will not accept any responsibility for any errors arising from the use of these files either by human error by the recipient, editing of un-audited measurements, compatibility issues with the recipient's software, and any errors arising from these files are used to add the recipient's drawing production, or setting out on site.

4. Datum:	
Existing Layout	
Proposed Layout	
Works Boundary	

Drawing Number		Rev
IBH0287 /0030		/
Project leader	Drawn By	Date
B.D	C.O.C	Sept 2011
		Initial Review
		C.O.C

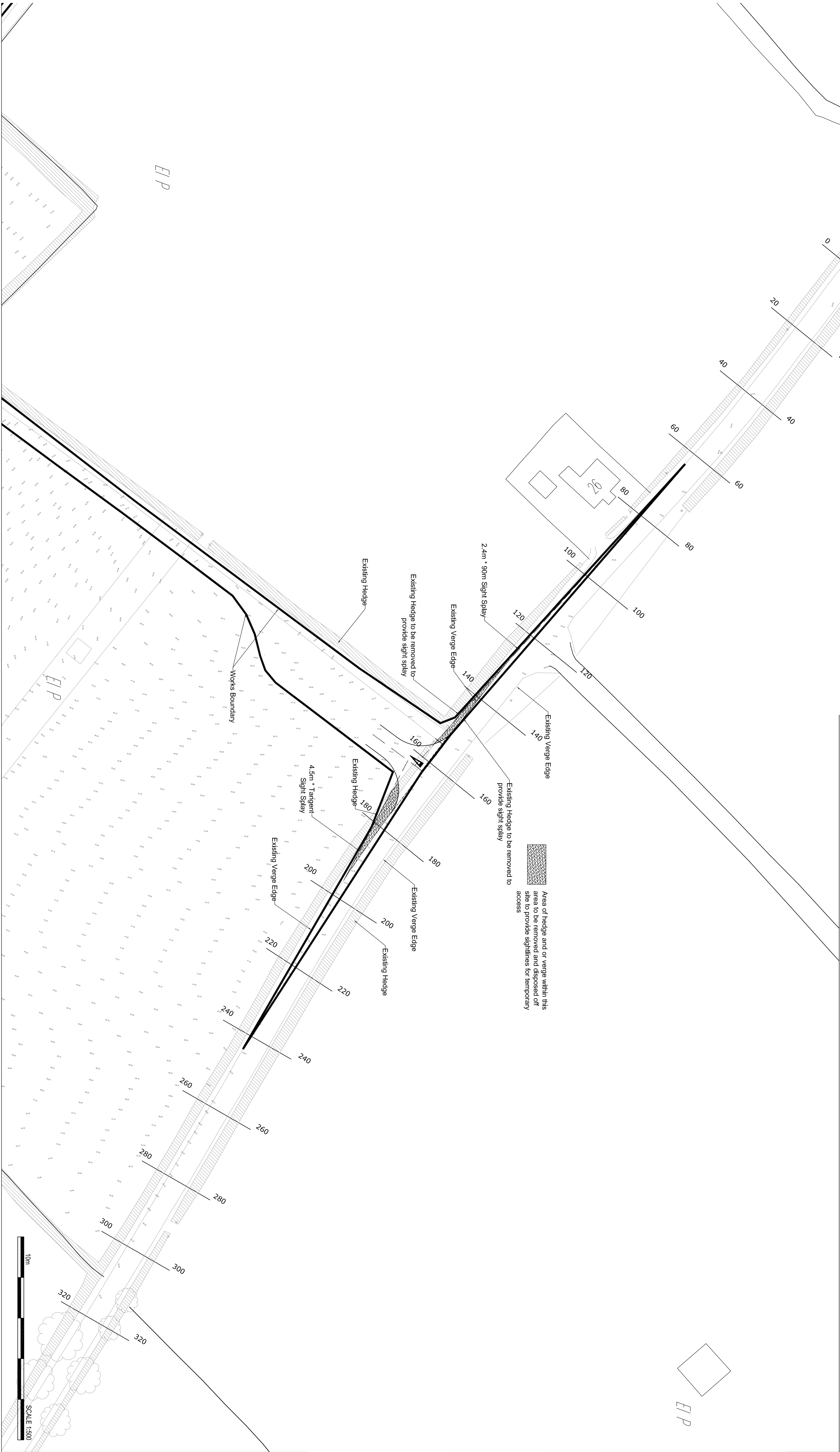

CHAINAGE	EXISTING LEVELS	LEVEL DATUM = 32.00
00.000	53.41	
20.000	53.75	
40.000	54.00	
60.000	53.75	1.05
80.000	52.80	
100.000	51.47	90m
120.000	49.77	
140.000	48.30	
160.000	46.75	1.05
180.000	44.98	90m
200.000	43.92	
220.000	42.82	
240.000	40.50	1.05
260.000	38.86	
280.000	37.16	
300.000	35.98	
320.000	35.21	

NOTES

1. Verifying Dimensions.
The contractor shall verify dimensions against such other drawings or site conditions as pertain to this part of the work.
2. Existing Services.
Any information concerning the location of existing services indicated on this drawing is intended for general guidance only. It shall be the responsibility of the contractor to determine and verify the exact horizontal and vertical alignment of all cables, pipes, etc. (both underground and overhead) before work commences.
3. Issue of Drawings.
Hard copies, dwf and pdf will form a controlled issue of the drawing. All other formats (dwg, dxf etc.) are deemed to be an uncontrolled issue and any work carried out based on these files is at the responsibility of the contractor. The contractor shall be responsible for any errors arising from the use of these files, either by issuing or by the recipient. Listing of undimensioned measurements, compatibility issues with the recipient's software, and any errors arising when these files are used to aid the recipient's drawing production, or setting out on site.
4. Datum:

Existing Layout	<div></div>
Proposed Layout	<div></div>
Works Boundary	<div></div>

VERTICAL 1:500		LEVEL DATUM = 20.0	
CHAINAGE	EXISTING LEVELS		
0.000	34.65		
9.12	34.74		
20.2	34.86		
31.3	34.84		
40.34	34.63		
51.22	34.61		
7315	34.93		
93.24	35.1		
105.18	35.4		
116.96	35.88		
130.19	36.46		
143.854	36.86		
159.524	37.17		
174.565	37.34		
189.814	37.52		
205.354	37.77		
218.444	38.25		
231.914	39.17		
246.848	39.88		

Site Access
Visibility

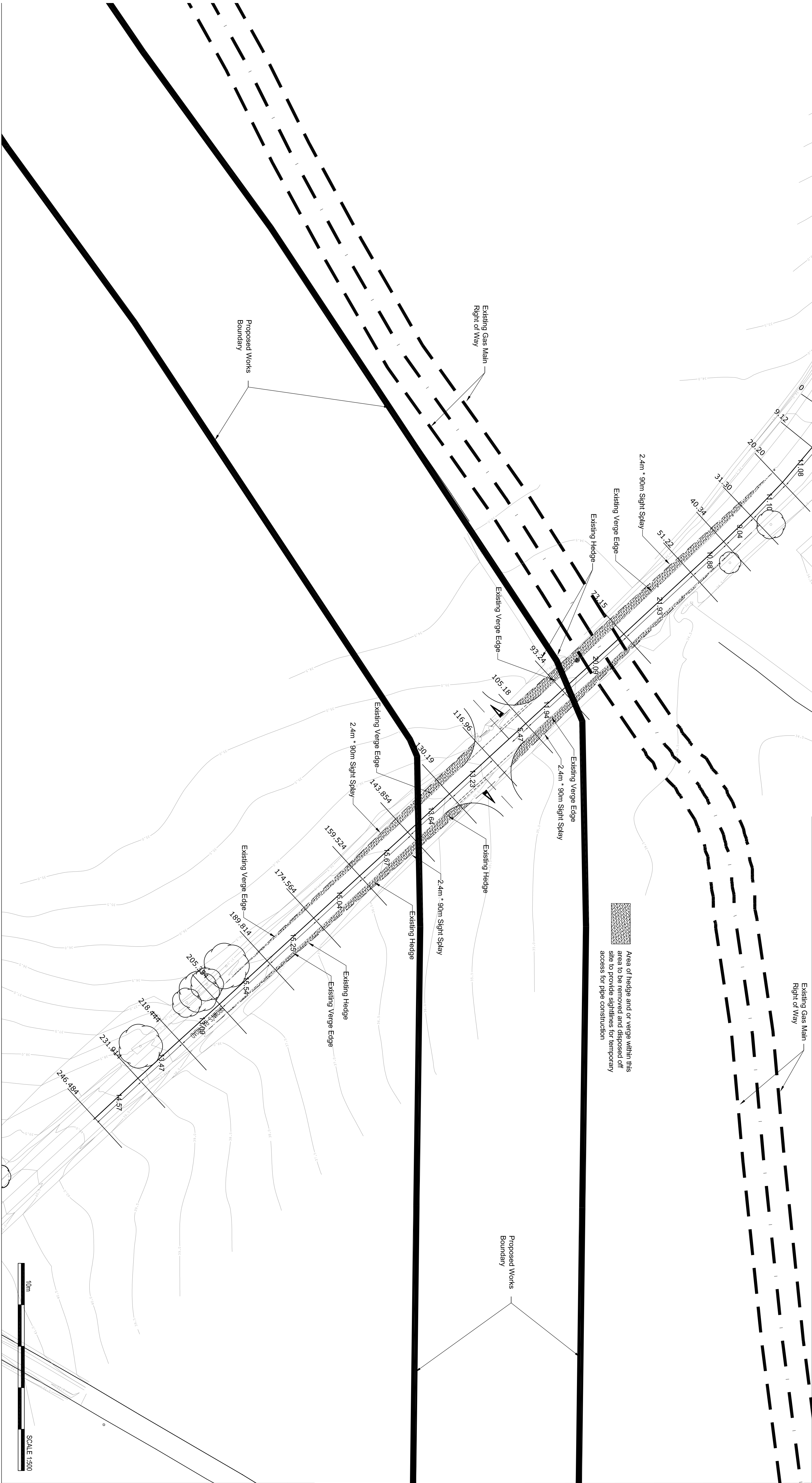

rev	amendments	drawn	date

Client	<div><div>RPS</div><div>Edmond House 74 Boucher Road Belfast BT12 6FZ E ireland@rpsgroup.com</div><div>T +44 (0) 28 90 667914 F +44 (0) 28 90 668286 W www.rpsgroup.com/ireland</div></div>		
Project	Islandmagee Gas Storage		
Title	Site Access 3 - Sea Water Intake Pumping Station and Brine Outfall		
Drawing Status	Sheet Size	Drawing Scale	
Preliminary	A1	AS SHOWN	
Drawing Number	Rev	/	
IBH0287 /0040			
Project Leader	Drawn By	Date	Initial Review
B.D	C.O.C	Sept 2011	C.O.C